

MODEL RE1201XE1-H01

BASIC DIMENSIONS	L ≤ 10	10 < L	100 ≤ L	ANGLE	UNIT
TOL.	±0.3	±0.5	±0.8	±5°	mm

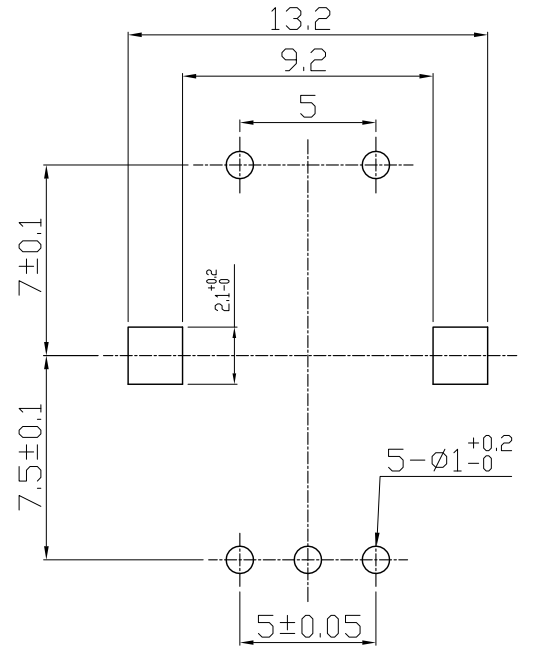

轴型规格

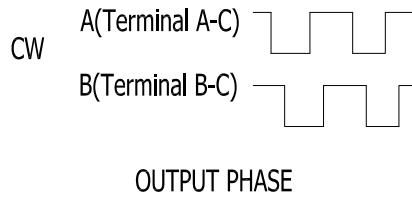
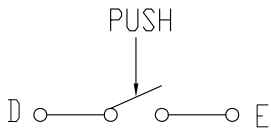
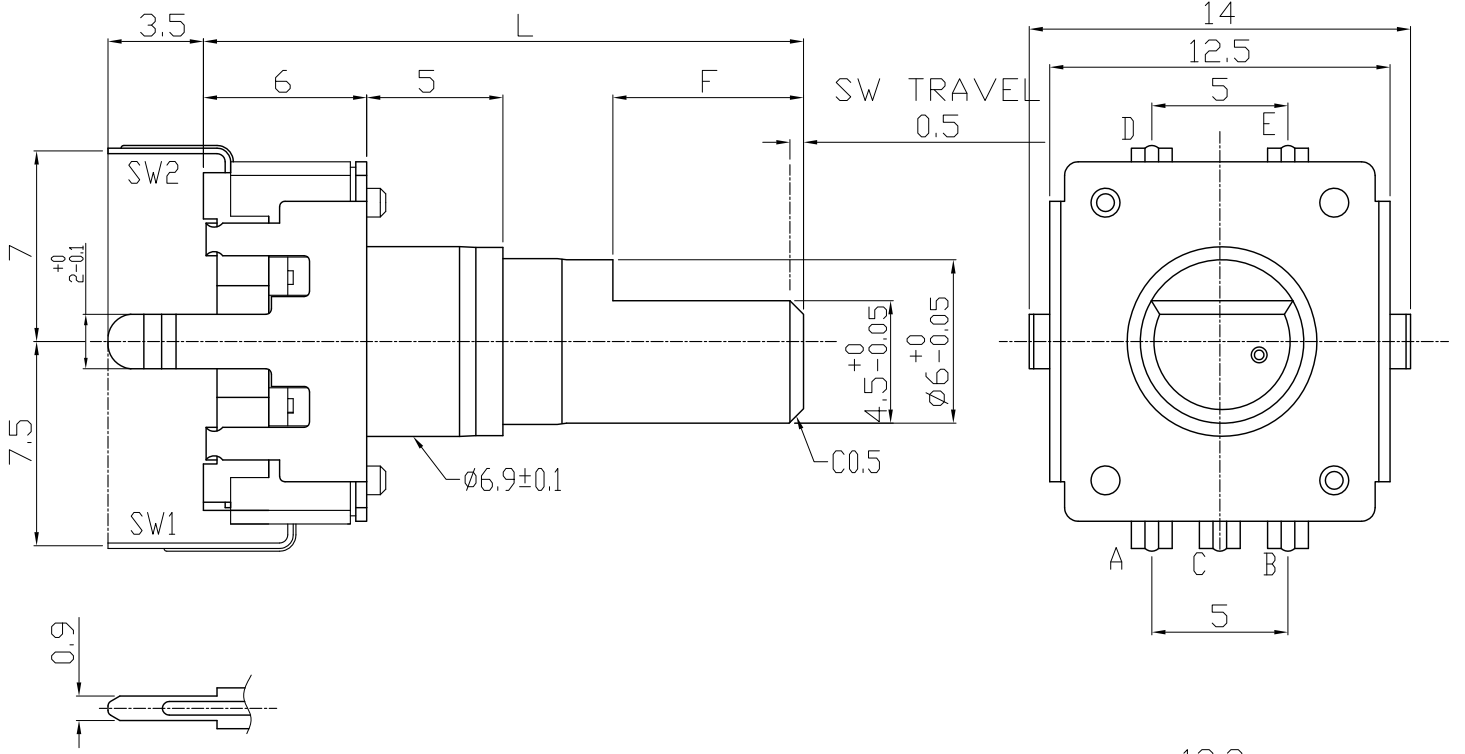
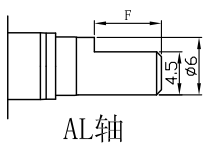

AL轴

无轴套

	L	17.5	20	22.5	25	30
F	5	7	7	12	10	

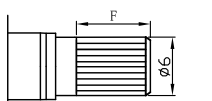

YL轴

无轴套

	L	15	17.5	20	22.5	25	30
F	2.5	5	7	7	12	12	

P.C.B.MOUNTING DETAIL